



GEO

SUBMERSIBLE SEWAGE PUMP

11~22kW 4P

50Hz : 1450rpm

60Hz : 1750rpm

Specifications

- **Capacity:** up to 860m³/h
- **Head:** up to 44 meters
- **Maximum immersion depth :** 20m
- **Cable length:** 8m
- **Insulation Class:** F
- **protection Class:** IP68
- **Starting Method:** reduced- voltage starting
- **water temperature:** up to 40 °C
- **PH:** 6 to 10
- **Density of liquid:** 1.3g/cm³
- **Power supply:** three phase 380V ± 10%,50Hz
380V ± 10%,60Hz



Authorized Distributor:

MOHAMMED AHMED AL-AWANI TRADING COMPANY

MASTCOSA DELIVERING SOLUTIONS Dewatering Pump Sales | Dewatering Accessories | Hoses & Fittings | Pump Parts | Pump Rental | Pump Service

E-mail: sales@mastoosa.com
www.mastcosa.com

Building No. 3192 - King Saud Street - Al
Amarah District Dammam - Zip Code
32415 - Additional No7068 - Unit No 73

Phone Number: +966 13 833 4575 +966
13 833 5156

Movable Hard Pipe Installation(Y)

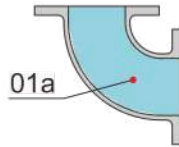

Movable Soft Pipe Installation (R)

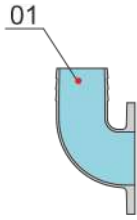

Auto-coupled Installation (Z)

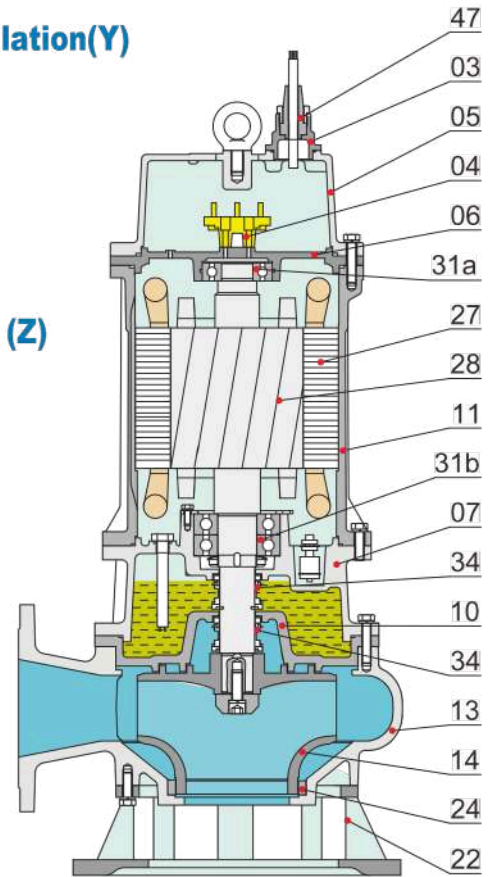
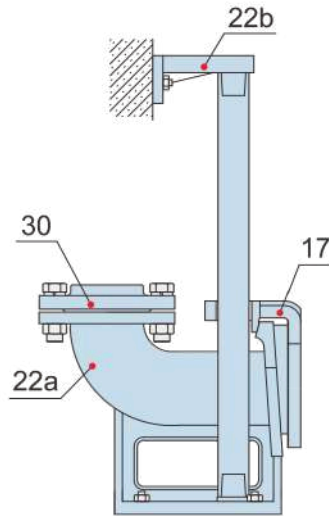

Material of construction

Item No.	Part name	Material
01	Hose coupling	Cast iron
01a	Hose coupling	Cast iron
03	Terminal box	Cast iron
04	Wiring terminal	
05	Upper cover	Cast iron
06	Up-Bearing house	Cast iron
07	Bearing house	Cast iron
10	Seal bracket	Cast iron
11	Motor body	Cast iron
13	Pump body	Cast iron
14	Impeller	Ductile iron
17	Coupling adapter	Cast iron
22	Seat assembly	Cast iron
22a	Coupling seat	Cast iron
22b	Upper guide support	Cast iron
24	Neck ring	High chrome alloy
27	Stator	
28	Rotor	Shaft : AISI420SS
30	Flange	Cast iron
31a	Bearing	Ball bearing
31b	Bearing	Ball bearing
34	Mechanical seal	Sic-Sic
47	Cable	

Authorized Distributor:

MOHAMMED AHMED AL-AWANI TRADING COMPANY



MASTCOSA DELIVERING SOLUTIONS Dewatering Pump Sales | Dewatering Accessories | Hoses & Fittings | Pump Parts | Pump Rental | Pump Service

E-mail: sales@mastcosa.com
www.mastcosa.com

Building No. 3192 - King Saud Street - Al
Amarah District Dammam - Zip Code
32415 - Additional No7068 - Unit No 73

Phone Number: +966 13 833 4575 +966
13 833 5156

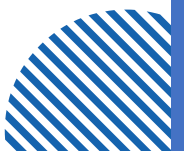

Performance curves

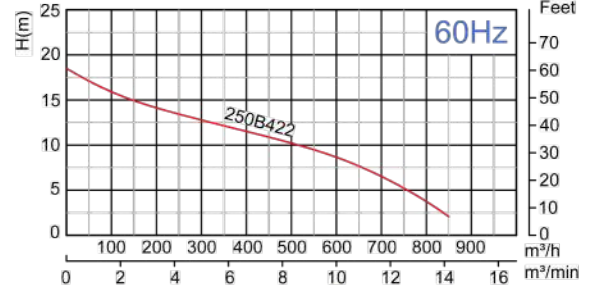
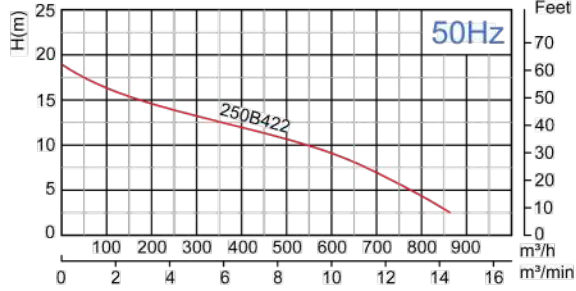
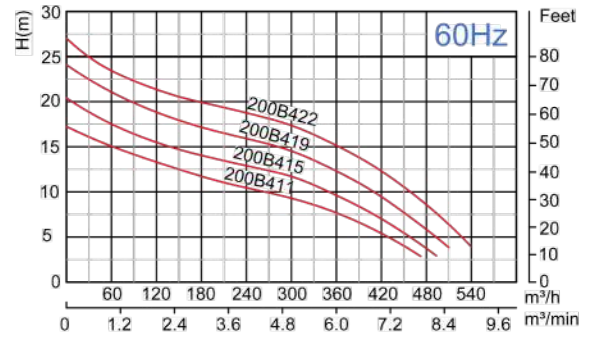
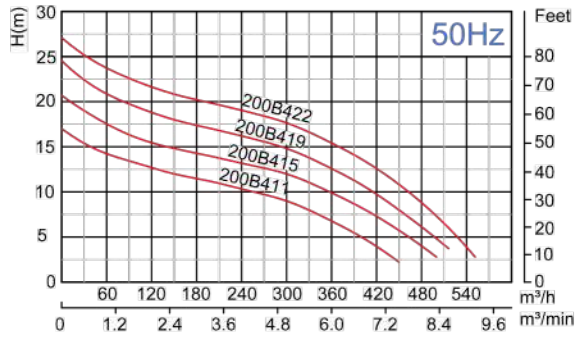
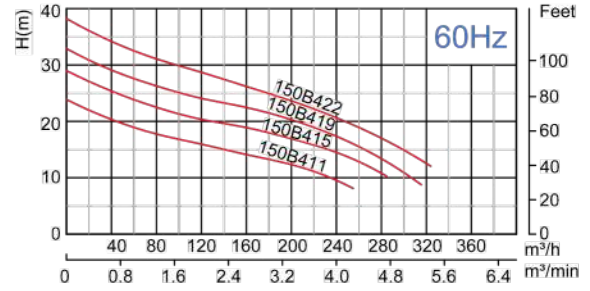
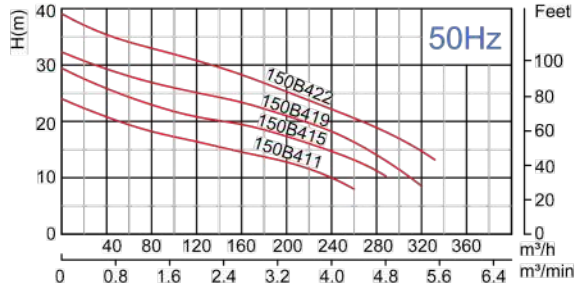
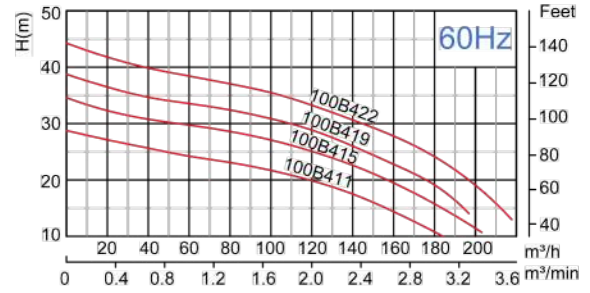
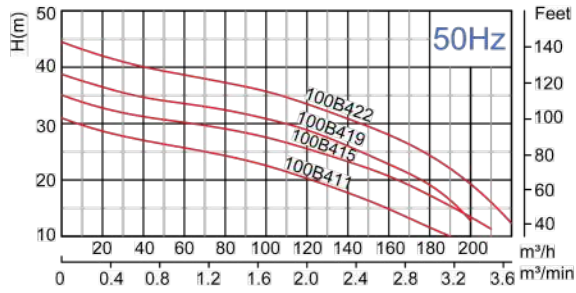

Performance table

Model	Voltage	Current	Motor power		Outlet		Rated capacity	Rated head	Max capacity	Max Head	Impeller Passage	Cable
			kW	HP	in	mm						
100B411	380	22	11	15	4	100	100	22	190	31/28	50	4G4.0
150B411	380	22	11	15	6	150	150	15	260	24	60	4G4.0
200B411	380	22	11	15	8	200	300	9	450/475	17	70	4G4.0
100B415	380	30.1	15	20	4	100	100	27	210	35	50	4G6.0
150B415	380	30.1	15	20	6	150	150	20	290	29	60	4G6.0
200B415	380	30.1	15	20	8	200	300	12	490	21	70	4G6.0
100B419	380	38	19	25	4	100	100	31	200	38	50	4G10.0
150B419	380	38	19	25	6	150	150	24	300	32	60	4G10.0
200B419	380	38	19	25	8	200	300	15	530	25	70	4G10.0
100B422	380	45	22	30	4	100	100	36	220	44	50	4G10.0
150B422	380	45	22	30	6	150	150	28	330	39	60	4G10.0
200B422	380	45	22	30	8	200	300	18	550	27	70	4G10.0
250B422	380	45	22	30	10	250	500	11	800	22	70	4G10.0



Authorized Distributor:
MOHAMMED AHMED AL-AWANI TRADING COMPANY

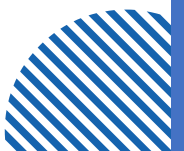

Movable Soft Pipe Installation (R)

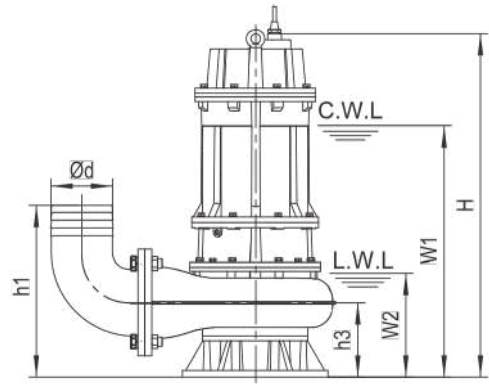
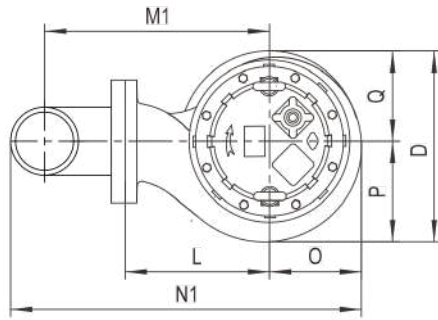

Movable Hard Pipe Installation (Y)

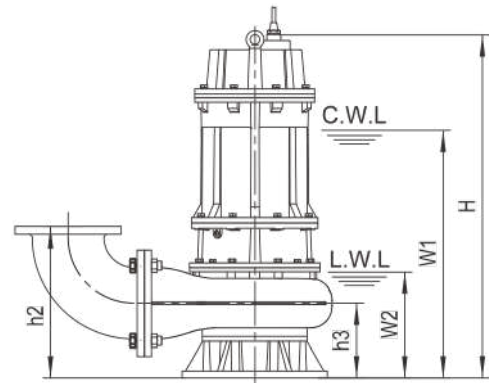
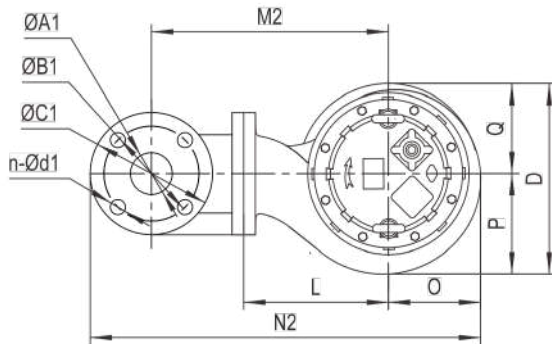

C.W.L : Continuous running water level
L.W.L : Lowest running water level

Dimensions table

Model	Ød	ØA1	ØB1	ØC1	n-Ød1	h1	h2	h3	W1	W2	H	O	P	Q	L	D	M1	M2	N1	N2
100B411	100	100	170	210	4-Ø18	355	335	185	650	255	910	210	217	210	310	427	412	462	672	777
150B411	150	150	225	265	8-Ø18	440	415	215	680	285	940	210	225	210	320	435	472	522	757	865
200B411	200	200	295	340	8-Ø22	545	465	235	720	325	980	225	253	210	340	463	542	572	868	968
100B415	100	100	170	210	4-Ø18	355	335	185	695	255	955	210	217	210	310	427	412	462	672	777
150B415	150	150	225	265	8-Ø18	440	415	215	725	285	985	210	225	210	320	435	472	522	757	865
200B415	200	200	295	340	8-Ø22	545	465	235	765	325	1025	225	253	210	340	463	542	572	868	968
100B419	100	100	170	210	4-Ø18	355	335	185	715	255	1010	218	227	210	325	437	427	477	695	800
150B419	150	150	225	265	8-Ø18	440	415	215	740	285	1035	220	235	210	335	445	487	537	783	890
200B419	200	200	295	340	8-Ø22	545	465	235	785	325	1080	233	260	210	350	470	552	582	885	985
100B422	100	100	170	210	4-Ø18	355	335	185	736	255	1030	218	227	210	325	437	427	477	695	800
150B422	150	150	225	265	8-Ø18	440	415	215	760	285	1055	220	235	210	335	445	487	537	783	890
200B422	200	200	295	340	8-Ø22	545	465	235	805	325	1100	233	260	210	350	470	552	582	885	985
250B422	-	250	350	395	12-Ø22	-	545	275	860	400	1160	280	313	270	400	583	-	673	-	1150

※Standard equipment of 250 mm outlet dimension does not include the bend hose coupling.

Weights & Packing dimensions

Model	R			Y		
	N.W kg	G.W kg	Packing dimension mm	N.W kg	G.W kg	Packing dimension mm
100B411	253	271	700×470×1100	259	277	700×470×1100
150B411	256	274	700×470×1130	264	282	700×470×1130
200B411	280	299	700×500×1170	288	307	700×500×1170
100B415	275	293	700×470×1150	281	299	700×470×1150
150B415	277	295	700×470×1170	285	303	700×470×1170
200B415	302	321	700×500×1220	310	329	700×500×1220
100B419	326	345	700×480×1240	332	351	700×480×1240

Model	R			Y		
	N.W kg	G.W kg	Packing dimension mm	N.W kg	G.W kg	Packing dimension mm
150B419	327	346	700×480×1240	335	354	700×480×1240
200B419	354	373	720×510×1280	362	381	720×510×1280
100B422	346	366	700×480×1240	352	372	700×480×1240
150B422	347	367	700×480×1240	355	375	700×480×1240
200B422	374	394	720×510×1280	382	402	720×510×1280
250B422	390	411	720×600×1300	400	421	720×600×1300



Authorized Distributor:

MOHAMMED AHMED AL-AWANI TRADING COMPANY

MASTCOSA DELIVERING SOLUTIONS Dewatering Pump Sales | Dewatering Accessories | Hoses & Fittings | Pump Parts | Pump Rental | Pump Service

E-mail: sales@mastcosa.com
www.mastcosa.com

Building No. 3192 - King Saud Street - Al
Amarah District Dammam - Zip Code
32415 - Additional No7068 - Unit No 73

Phone Number: +966 13 833 4575 +966
13 833 5156

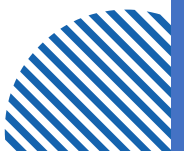

Auto-Coupled Installation (Z)

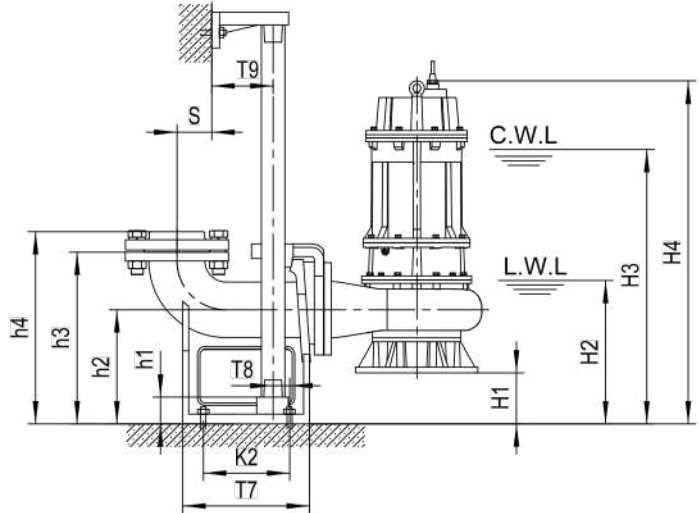
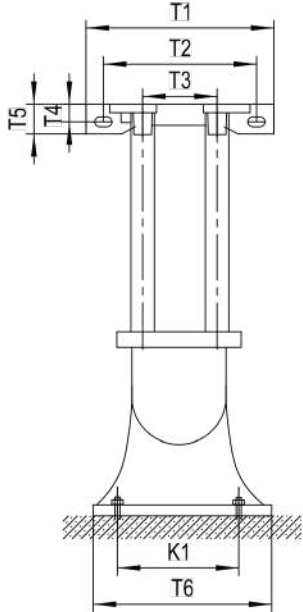

C.W.L : Continuous running water level

L.W.L : Lowest running water level

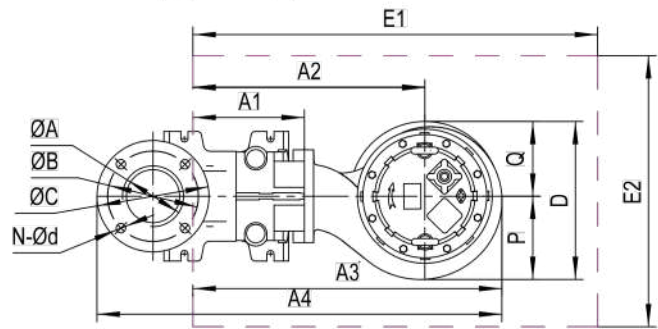

Dimensions table

Auto coupling	ØA	ØB	ØC	N-Ød	T1	T2	T3	T4	T5	T6	T7	T8	T9	K1	K2	S	h1	h2	h3	h4
100-100(PN6)	Ø100 / G4"	170	210	4-Ø18	365	305	170	32	55	295	260	35	95	265	175	100	25	230	350	380
150-150(PN6)	Ø150	225	265	8-Ø18	400	260	280	24	48	400	410	75	95	280	300	200	390	300	480	—
200-200(PN10)	Ø200	295	340	8-Ø22	400	260	280	24	48	400	445	100	95	300	355	230	440	325	555	—
250-250(PN10)	Ø250	350	395	12-Ø22	400	260	280	24	48	460	555	110	95	360	430	295	460	315	630	—

※Standard equipment of 150,200,250mm outlet dimension does not include flange.

Dimensions table

Model	Auto coupling	H1	H2	H3	H4	A1	A2	A3	A4	P	Q	D	E1×E2	Pump weight & packing dimension		
														N.W	G.W	Packing dimension
100B411	100-100(PN6)	45	300	695	955	200	510	720	925	217	210	427	900×600	247	265	700×470×1100
150B411	150-150(PN6)	85	370	765	1025	285	605	815	1155	225	210	435	1050×650	244	262	700×470×1130
200B411	200-200(PN10)	90	415	810	1070	285	625	850	1250	253	210	463	1050×650	255	284	700×500×1170
100B415	100-100(PN6)	45	300	740	1000	200	510	720	925	217	210	427	900×600	269	287	700×470×1150
150B415	150-150(PN6)	85	370	810	1070	285	605	815	1155	225	210	435	1050×650	265	283	700×470×1170
200B415	200-200(PN10)	90	415	855	1115	285	625	850	1250	253	210	463	1050×650	277	296	700×500×1220
100B419	100-100(PN6)	45	300	760	1055	200	525	743	950	227	210	437	900×600	320	339	700×480×1240
150B419	150-150(PN6)	85	375	825	1120	285	620	840	1180	235	210	445	1050×650	315	334	700×480×1240
200B419	200-200(PN10)	90	420	875	1170	285	635	868	1265	260	210	470	1050×650	329	348	720×510×1280
100B422	100-100(PN6)	45	300	780	1075	200	525	743	950	227	210	437	900×600	340	360	700×480×1240
150B422	150-150(PN6)	85	375	845	1140	285	620	840	1180	235	210	445	1050×650	335	355	700×480×1240
200B422	200-200(PN10)	90	420	895	1190	285	635	868	1265	260	210	470	1050×650	349	369	720×510×1280
250B422	250-250(PN10)	40	400	860	1160	310	710	990	1482	313	270	583	1100×850	360	381	720×600×1300



Authorized Distributor:

MOHAMMED AHMED AL-AWANI TRADING COMPANY

MASTCOSA DELIVERING SOLUTIONS Dewatering Pump Sales | Dewatering Accessories | Hoses & Fittings | Pump Parts | Pump Rental | Pump Service

E-mail: sales@mastcosa.com
www.mastcosa.com

Building No. 3192 - King Saud Street - Al
Amarah District Dammam - Zip Code
32415 - Additional No7068 - Unit No 73

Phone Number: +966 13 833 4575 +966
13 833 5156

